

PANZITTA SALES & SERVICE  
72 George Avenue  
Wilkes-Barre, PA 18705  
570-822-6720 800-822-6720  
www.panzittasales.com



**SWIRL FINISHER**  
- OPERATING & SERVICE INSTRUCTIONS WITH PARTS IDENTIFICATION -

**MODEL 8750**

AMMCO TOOLS, INC. / WACKER PARK / NORTH CHICAGO, ILLINOIS 60064 U.S.A.  
(615) 793-7533 Customer Service #: (800) 323-6852



**CAUTION**

Eye and face protection recommendations:

"Protective eye and face equipment is required to be used where there is a reasonable probability of injury that can be prevented by the use of such equipment." O.S.H.A. 1910.133 (a).

Protective goggles, safety spectacles, or a face shield must be provided by the purchaser/user and worn by the operator of the equipment. Care should be taken to see that all eye and face safety precautions are followed by the operator.

*It's not only the law — it's good sense.*

Use the Model 8750 Swirl Finisher to produce a "non-directional" finish on machined rotors when recommended by the manufacturer.

The swirl finisher is powered by the arbor, through a drive socket plugged onto the arbor nut.

**SWIRL FINISHING ON THE LATHE**

1. Peel the paper backing from the back of an abrasive disc, then center the abrasive disc on the rubber sanding pad and press in place.
2. Slip the driver socket onto the arbor nut.
3. Move the twin cutter out of the way to permit free access to both rotor faces.
4. Grasp the swirl finisher firmly and start the lathe. Press the rotating abrasive disc against each rotor surface for approximately 5 seconds to produce a "non-directional" swirl finish.

NOTE: An optional 1¼" Arbor Nut (P.N. 25882) is required when using the Model 8750 Swirl Finisher with a No. 9708 1½" Arbor Set on Models 4000, 4100, 000, 2002, and 6000 Lathes.

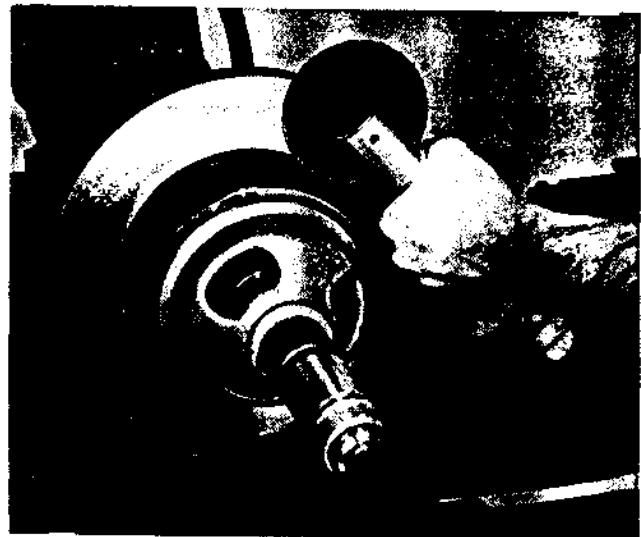

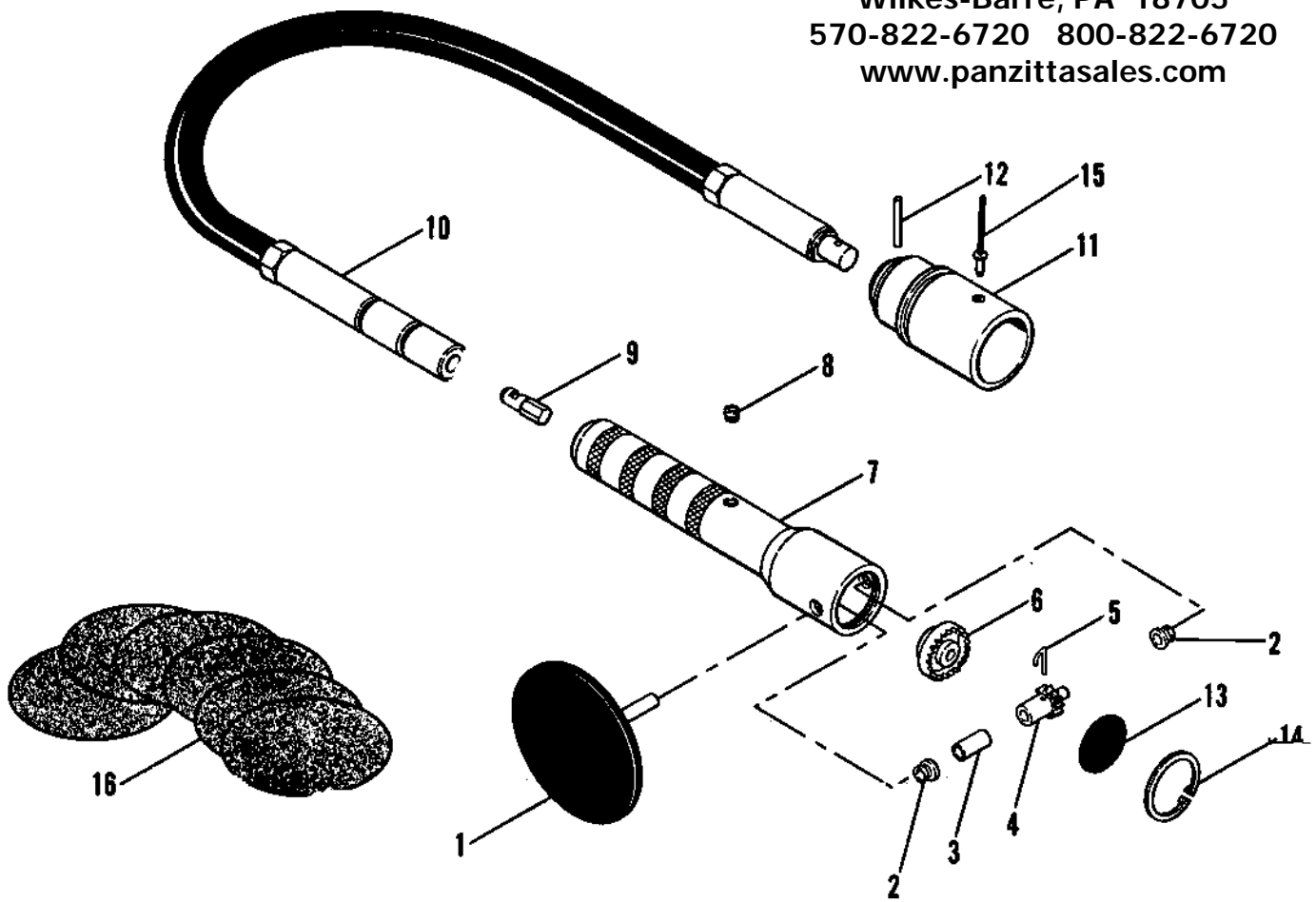

ITEM	PART NO.	QTY.	DESCRIPTION
1	26698	1	Pad, Sanding
2	26702	2	Bearing
3	26701	1	Spacer
4	26700	1	Pinion
5	26703	1	Pin, Retaining
6	25008	1	Gear, Face
7	26035	1	Body, Finisher
8	26722	1	Screw, Set
9	26704	1	Driver, Hex
10	26032	1	Shaft, Flex
11	26033	1	Driver (with 642→ 11 Pin)
12	6424	1	Pin, Roll
13	26202	1	Nameplate
14	26203	2	Ring, Retaining
15	25880	1	Rivet, Pop
16	8756	1	Pad, Abrasive, 120 Grit - Pkg. of 6